

# DIRECTIONS FOR USE

## ⚠ WARNING

To avoid potential eye injury and cuts and burns to your body, read and follow the enclosed safety precautions insert before using flexi leash.

**SAFETY LOOP:** Always use the enclosed safety loop ② in addition to your dog's collar ① as illustrated. If your dog's collar breaks, the safety loop will stay attached to your dog. This will prevent the leash from retracting unexpectedly and the hook ⑧ from possibly hitting you in the eye.

**TO ATTACH LEASH:** Be sure to have your dog under control before attempting to attach the leash. With the leash fully retracted into its case, put the safety loop ② around the dog's neck near the collar. Attach both rings of the safety loop ② and the dog's collar to the hook ⑧ on the leash.

**TO OPERATE:** Hold the flexi leash by the handle ③, not the cord ⑥. The cord ⑥ will run in and out freely without sagging.

**TO STOP LEASH:** Press the brake button ④ down firmly.

**TO SET BRAKE LOCK:** Press the brake button ④ down firmly and push the locking pin ⑤ in.

**TO RELEASE BRAKE LOCK:** Press the brake button ④, push back the locking pin ⑤, then slowly release brake button ④.

**TO WALK TO HEEL:** Use the brake lock ⑤.

**TO BRING YOUR DOG NEARER:** Extend your arm towards the dog, apply the brake ④ and bring your arm to your side again. Release the brake ④ and repeat the movement as necessary.

**FOR CLOSER CONTROL:** Use the nylon hand loop ⑦ provided on the leash. Do not grab or pull on the cord ⑥.

**TO DETACH LEASH:** Before attempting to detach leash, be sure your dog is under control, the leash is fully retracted, and the brake is locked.

**WET CORD:** If the cord ⑥ gets wet, pull it out of the casing as far as it will go, lock brake and leave it to dry overnight. Keep it out of reach of children.

### LIMITED WARRANTY:

This flexi retractable leash (including all parts) is warranted by the manufacturer, Bogdahn Technik GmbH, for a period of one year from the date of purchase to be free from defects in materials and workmanship (see insert for details).

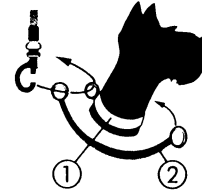

SAFETY LOOP

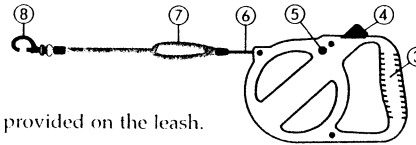

flexi-LEASH



FLEXI USA INC. · 4670 J INTERSTATE DR. · CINCINNATI · OHIO 45246 · TEL. (513)874-5383

USA