

XL MANUAL CHUTE

WITH RIGHT-HAND EXIT

ASSEMBLY INSTRUCTIONS

#002-10052

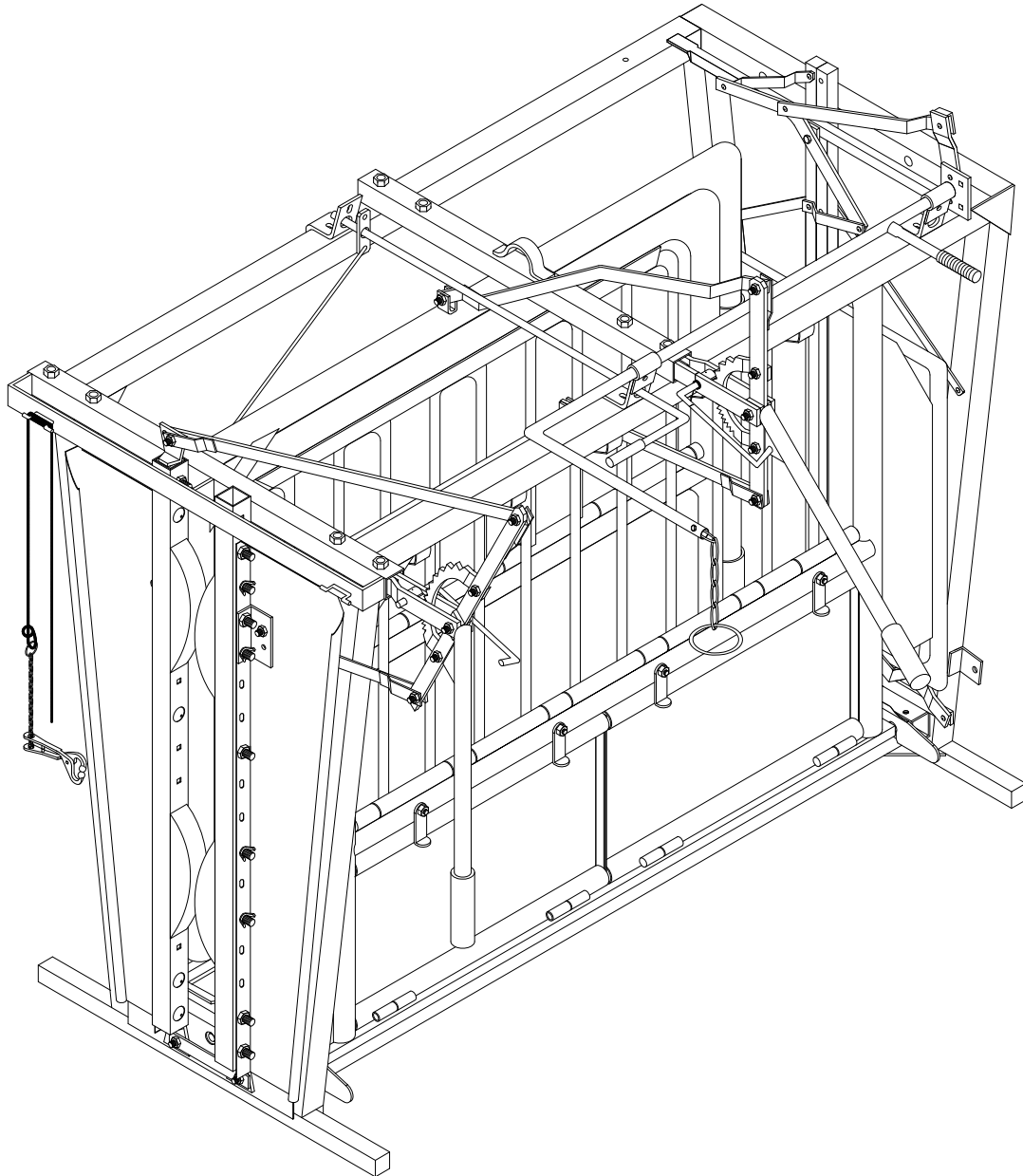

POWDER RIVER

• LIVESTOCK HANDLING EQUIPMENT •

www.powderriver.com

1-800-453-5318

NOTE: When assembling a left-hand exit Chute, some procedures will be opposite from the pictures.

STEP 1:

Remove all packaging from the Chute and make sure that each part in figure 1 is accounted for.

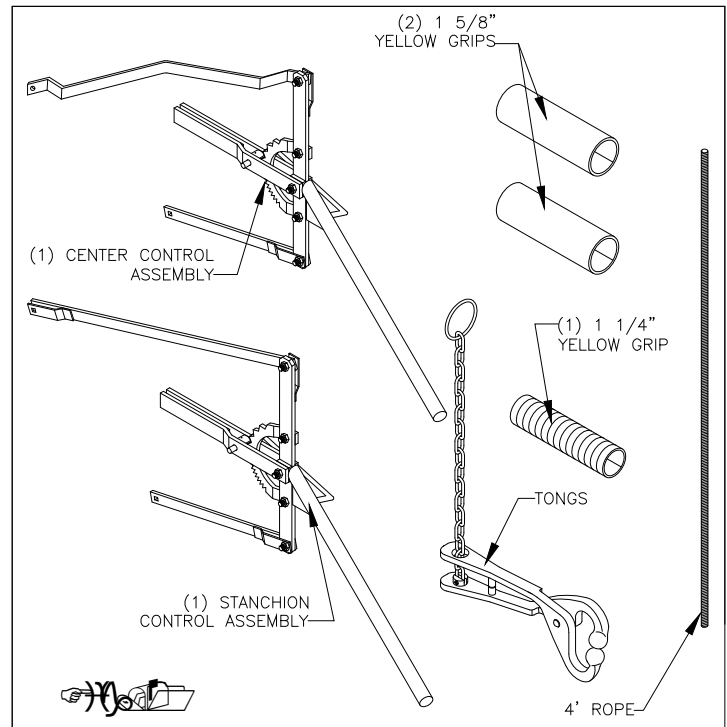

STEP 2:

Remove the two carriage bolts from the Long and Short Stanchion Straps.

Loosen the two Set Screws on the front square tube. Slide the Stanchion Control Handle all the way into the front square tube and tighten the Set Screws so that the Control Handle is secured to the Chute as shown in figure 2.

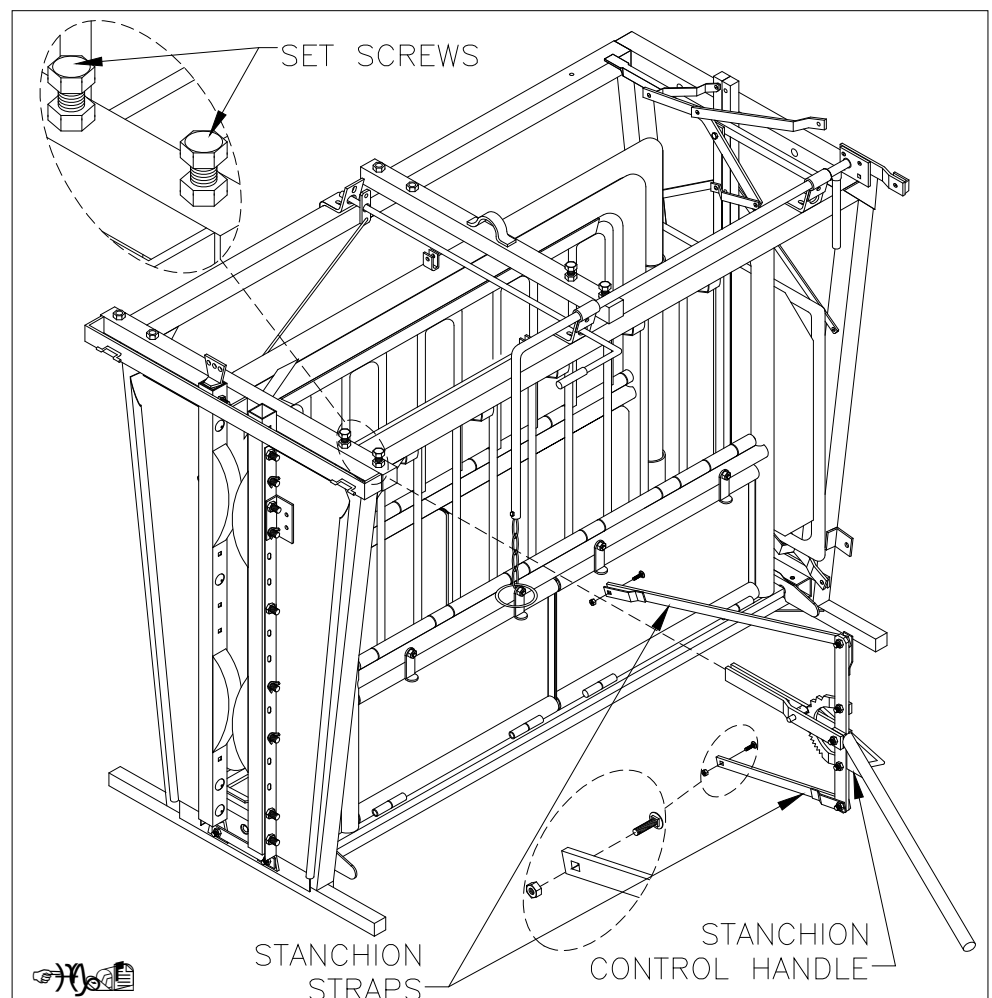

POWDER RIVER
 • LIVESTOCK HANDLING EQUIPMENT •

STEP 3:

Secure the Long Stanchion Strap to the far hole on the Insert Bracket as shown in figure 3.

Slide the Short Stanchion Strap behind the Stanchion Cover and secure it to the Stanchion Cover as shown.

NOTE: When the Head Gate is completely closed, the Stanchion Control Handle should be at the last notch on the Ratchet. If it is not at the last notch, you will need to move the Long Stanchion Strap to another hole on the Insert Bracket. This will allow the Head Gate to open as far as possible.

Loosen the two set screws on the middle square tube and slide the Center Control Assembly into the square tube as far as possible. Tighten the Set Screws to secure the Center Control Assembly to the Chute.

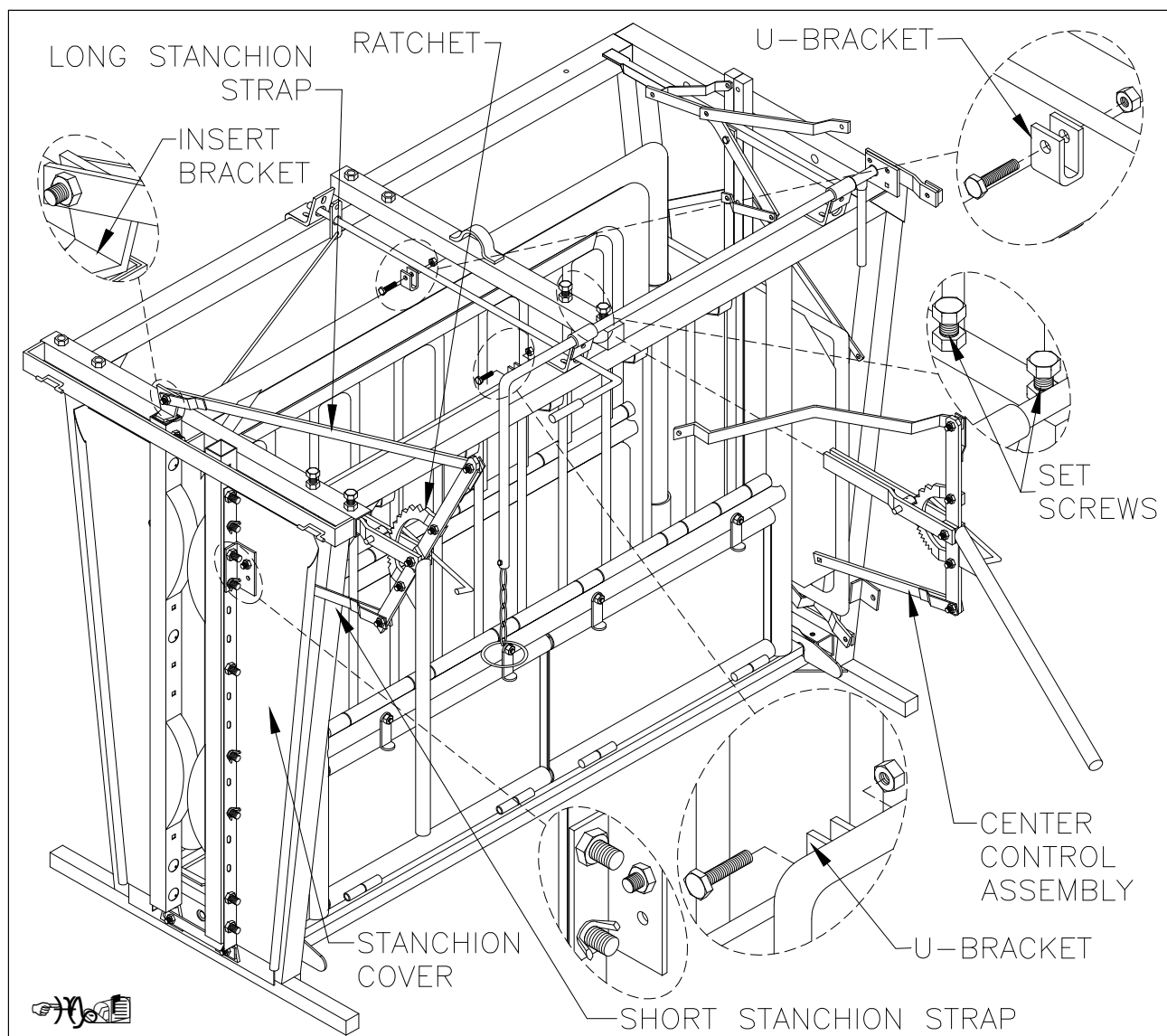

Remove the two bolts from the U-Brackets on the sides of the Chute as shown in figure 3.



STEP 4:

Bolt the Long Center Strap to the U-Bracket on the far side of the Chute as shown in figure 4.

Bolt the Short Center Strap to the U-Bracket on the other side of the Chute as shown.

Lift the Tailgate Handle up so that the Bell Crank on the end of the handle can be bolted to the Tailgate Strap as shown in figure 4.

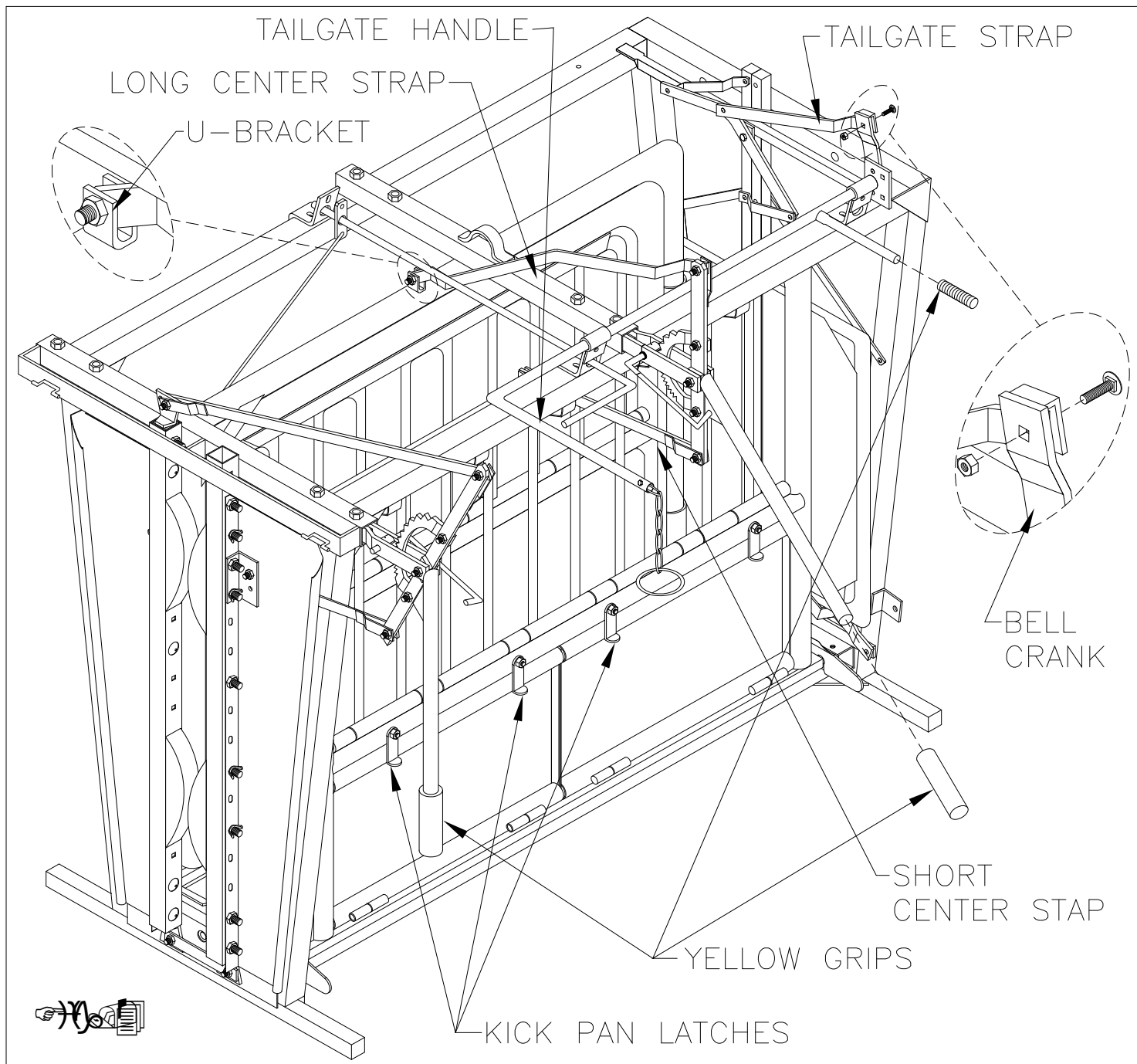

Loosen the (8) bolts that hold the Kick Pan Latch in place, so that they can rotate freely.

Slide the three Yellow Grips on the ends of the handles as shown.

***NOTE:** The XL Manual Side Exit Chute comes with several features that are adjustable. By adjusting them to best fit a specific type of animal, the Side Exit Chute is more effective. The following are some of the features of the chute that can be modified to better suit varying types of animals.*

Chute Width Adjustment:

To adjust the width of the Chute, lift the Side Retainer as shown in figure 5. (The center bolt may need to be loosened in order to lift the

Side Retainers) Then slide the side of the Chute to the desired slot on the Side Retainer. Secure the side in place by pushing the Side Retainer down into place.

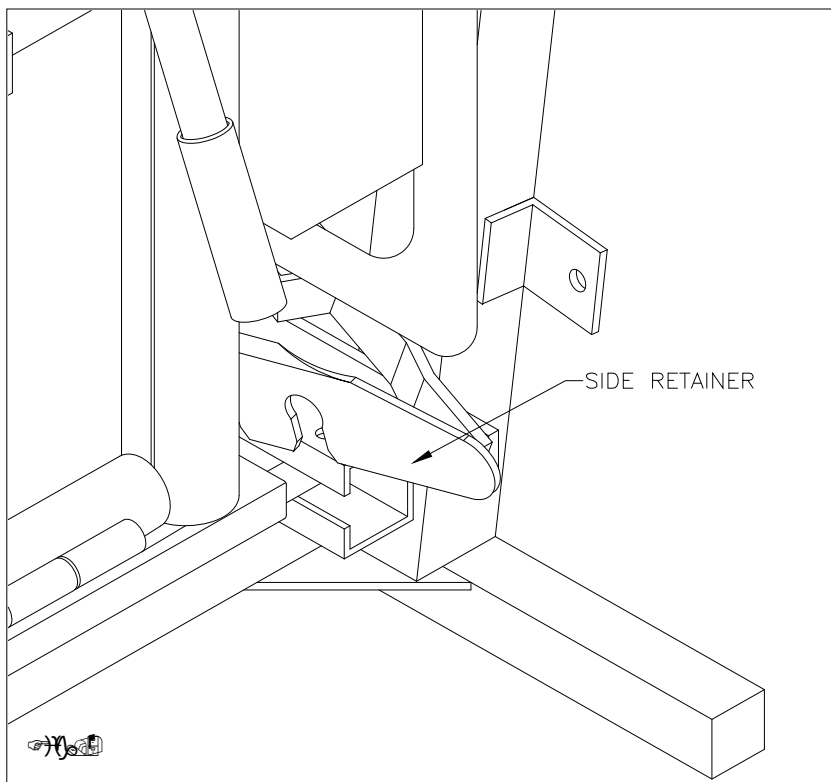

Yoke Assembly Adjustment:

To adjust the Yoke assemblies, remove the two wing nuts that hold the Yokes in place, and move them to the desired height as shown in figure 6.

